

**KEY PLAN**  
 1878 LE BER STREET  
 MONTREAL, QC, H3K 2A4

**STUDIO 6**

LOAD CAPACITY FOR SUMMER SEASON  
 PLEASE REFER TO DETAILED STRUCTURAL  
 ENGINEER LOAD PLANS (GRANDE STUDIOS)  
 FOR SUMMER AND WINTER SEASON

**STUDIO 6**  
 80'-4" X 160'-10" X 32'-5" CLEAR UNDER STEEL BEAMS  
 12 269 SQ. FT. 1139, 82 SQ.M.

**STEEL PURLIN W10 / W12**  
 DEAD LOAD= 21 LBS / SQ. FT.

**TEMPORARY EQUIPEMENT LOAD**

ONE POINT= 4400 lbs  
 TWO POINTS @8'-0" C/C= 4400 lbs  
 UNIFORM LOAD= 500 LBS/ LINEAR FOOT  
 LOAD EVERY 4 FEETS C/C 2000 lbs

**OPEN WEB STEEL BEAM**  
 DEAD LOAD= 21 lbs/ SQ. FT.

**TEMPORARY EQUIPEMENT LOAD**

ONE POINT= 2000 lbs AT JUNCTION ONLY  
 AND ON THE PURLIN DIRECTION  
 REFER TO DETAILED STRUCTURAL DRAWINGS

**FLOOR CAPACITY:**  
**CONCRETE SLAB**

**ELECTRICAL CAPACITY:**  
 TO BE CONFIRMED

**SCHEDULE**

- SURFACE MOUNTED 2'-0" X 4'-0" LIGHT FIXTURE APPROXIMATE LOCATION
- A/C DUCTS @0'-0" CLEAR UNDER CONDUITS
- FLEXIBLE A/C DUCTS @54'-9" CLEAR UNDER CONDUITS
- WIRES PASS
- FIRE EXTINGUISHER

DATE : 20-09-2023

**GRANDE**  
 STUDIOS

CLIENT :  
**MTL GRANDE STUDIOS**  
 1870 LE BER STREET, MONTREAL  
 QC, H3K 2A4

**STUDIO 6**  
**PLAN**

SCALE= 1/8"=1'-0" A1

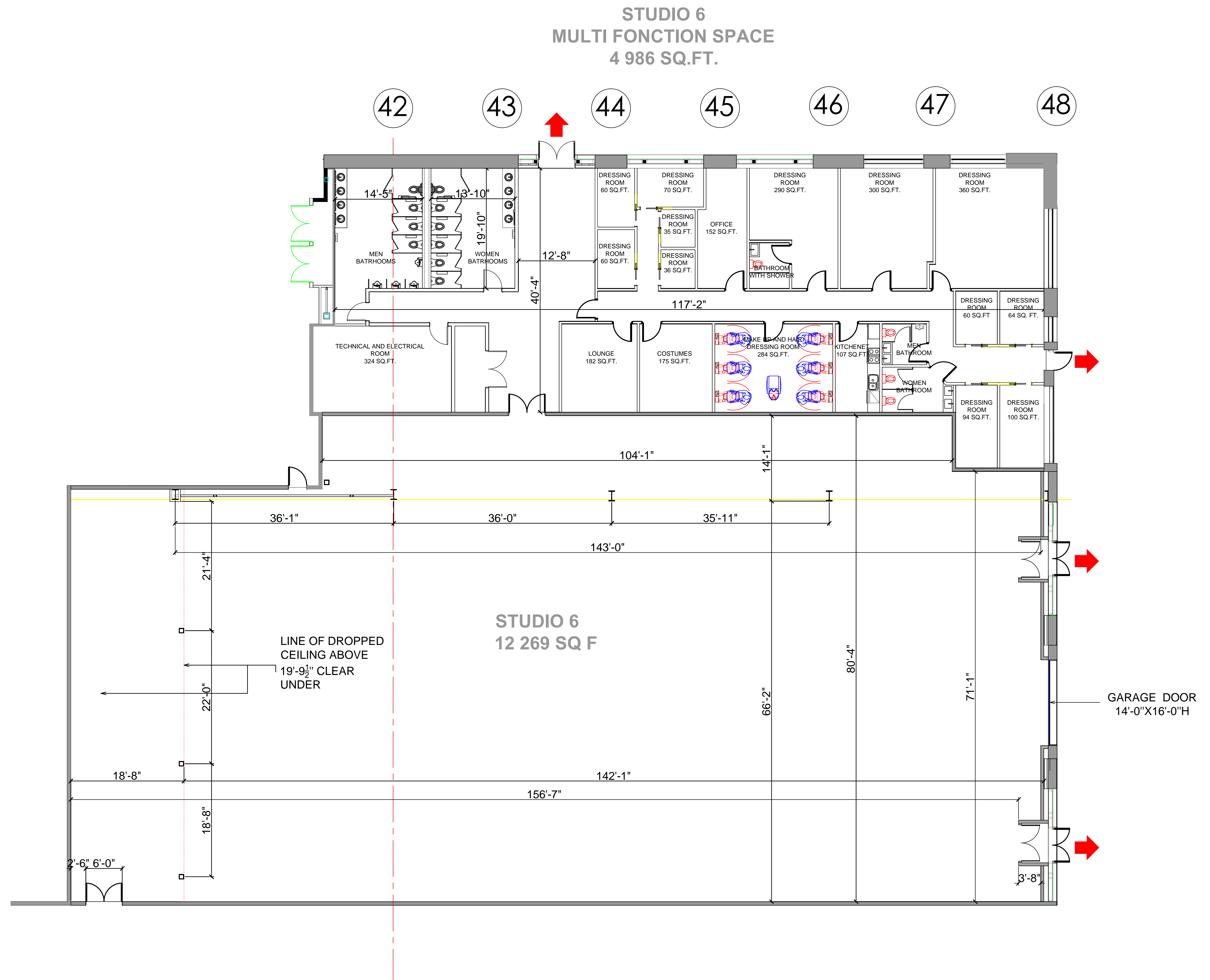

**STUDIO 6**  
 MULTI FONCTION SPACE  
 4 986 SQ.FT.

42 43 44 45 46 47 48

**STUDIO 6**  
 12 269 SQ F

LINE OF DROPPED  
 CEILING ABOVE  
 19'-9 1/2" CLEAR  
 UNDER

GARAGE DOOR  
 14'-0" X 16'-0" H

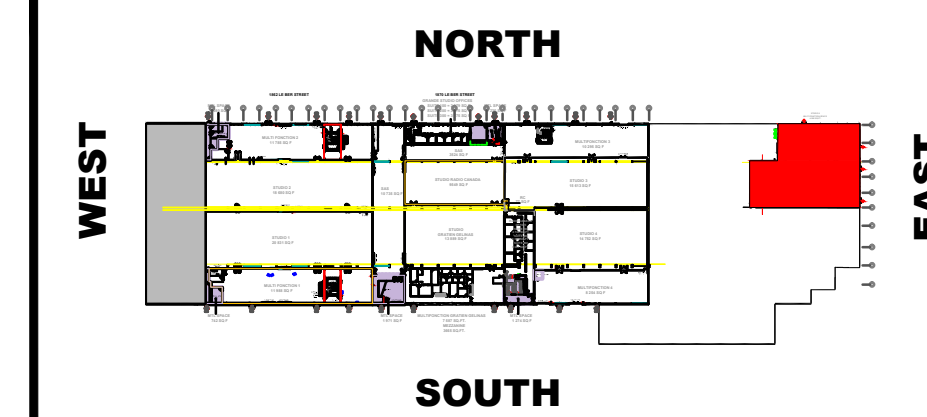

**KEY PLAN**  
**1878 LE BER STREET**  
**MONTREAL, QC, H3K 2A4**

**STUDIO 6**

LOAD CAPACITY FOR SUMMER SEASON  
 PLEASE REFER TO DETAILED STRUCTURAL  
 ENGINEER LOAD PLANS (GRANDE STUDIOS)  
 FOR SUMMER AND WINTER SEASON

**STUDIO 6**  
 80'-4" X 160'-10" X 32'-5" CLEAR UNDER STEEL BEAMS  
 12 269 SQ. FT. 1139, 82 SQ.M.

**STEEL PURLIN W10 / W12**  
 DEAD LOAD= 21 LBS / SQ. FT.

**TEMPOARY EQUIPMENT LOAD**  
 ONE POINT= 4400 lbs  
 TWO POINTS @8'-0" C/C= 4400 lbs  
 UNIFORM LOAD= 500 LBS/ LINEAR FOOT  
 LOAD EVERY 4 FEETS C/C 2000 lbs

**OPEN WEB STEEL BEAM**  
 DEAD LOAD= 21 lbs/ SQ. FT.

**TEMPOARY EQUIPMENT LOAD**  
 ONE POINT= 2000 lbs AT JUNCTION ONLY  
 AND ON THE PURLIN DIRECTION  
 REFER TO DETAILED STRUCTURAL DRAWINGS

**FLOOR CAPACITY:**  
 CONCRETE SLAB

**ELECTRICAL CAPACITY:**  
 TO BE CONFIRMED

**SCHEDULE**

- SURFACE MOUNTED  
2'-0"X4'-0" LIGHT FIXTURE  
APPROXIMATE LOCATION
- A/C DUCTS  
@0'-0" CLEAR UNDER CONDUITS
- FLEXIBLE A/C DUCTS  
@54'-9" CLEAR UNDER CONDUITS
- WIRES PASS
- FIRE EXTINGUISHER

**DATE : 20-09-2023**

**GRANDE**  
 STUDIOS

CLIENT:  
**MTL GRANDE STUDIOS**  
**1862 LE BER STREET, MONTREAL**  
**QC, H3K 2A4**

**STUDIO 6**  
**CEILING PLAN**

SCALE= 1/8"=1'-0" A2



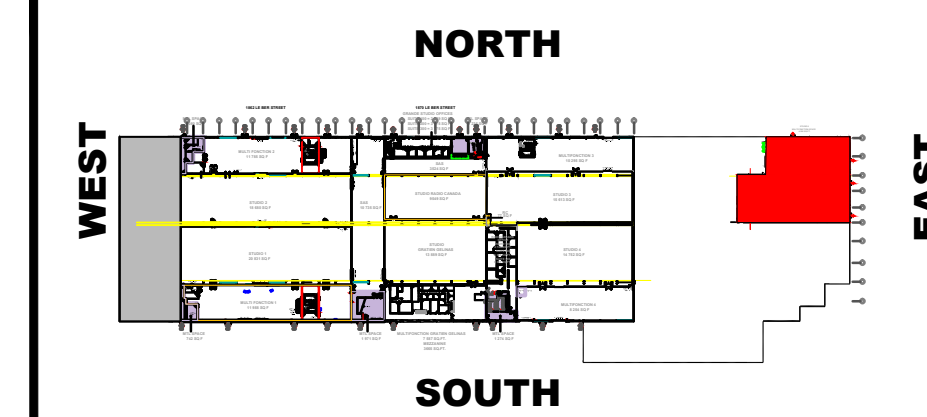

**KEY PLAN**  
**1878 LE BER STREET**  
**MONTREAL, QC, H3K 2A4**

**STUDIO 6**

LOAD CAPACITY FOR SUMMER SEASON  
 PLEASE REFER TO DETAILED STRUCTURAL  
 ENGINEER LOAD PLANS (GRANDE STUDIOS)  
 FOR SUMMER AND WINTER SEASON

**STUDIO 6**  
 80'-4" X 160'-10" X 32'-5" CLEAR UNDER STEEL BEAMS  
 12 269 SQ. FT. 1139, 82 SQ.M.

**STEEL PURLIN W10 / W12**  
 DEAD LOAD= 21 LBS / SQ. FT.

**TEMPORARY EQUIPMENT LOAD**  
 ONE POINT= 4400 lbs  
 TWO POINTS @8'-0" C/C= 4400 lbs  
 UNIFORM LOAD= 500 LBS/ LINEAR FOOT  
 LOAD EVERY 4 FEETS C/C 2000 lbs

**OPEN WEB STEEL BEAM**  
 DEAD LOAD= 21 lbs/ SQ. FT.

**TEMPORARY EQUIPMENT LOAD**  
 ONE POINT= 2000 lbs AT JUNCTION ONLY  
 AND ON THE PURLIN DIRECTION  
 REFER TO DETAILED STRUCTURAL DRAWINGS

**FLOOR CAPACITY:**  
**CONCRETE SLAB**

**ELECTRICAL CAPACITY:**  
 TO BE CONFIRMED

- SCHEDULE**
- SURFACE MOUNTED  
2'-0"X4'-0" LIGHT FIXTURE  
APPROXIMATE LOCATION
  - A/C DUCTS  
@0'-0" CLEAR UNDER CONDUITS
  - FLEXIBLE A/C DUCTS  
@54'-9" CLEAR UNDER CONDUITS
  - WIRES PASS
  - FIRE EXTINGUISHER

**DATE : 20-09-2023**

**GRANDE**  
 STUDIOS

CLIENT :  
**MTL GRANDE STUDIOS**  
**1862 LE BER STREET, MONTREAL**  
**QC, H3K 2A4**

**STUDIO 6**  
**SECTION**

SCALE= 3/16"=1'-0" A3

